

## Introduction

This guide will show you how to connect to Griffith University Wi-Fi network on an iPhone or iPad device.

**Before you start** - You must be on campus to complete the setup. You also need to close out of all applications using Wi-Fi/Internet before attempting the steps in this guide (including Outlook and Microsoft 365).

Screenshots in this guide may differ depending on device and software versions.

## Have you connected to Griffith Wi-Fi or Eduroam from your device before?

**No** – Continue to **Part A: Connect to \*Setup Griffith Wi-Fi**.

**Yes** – You will need to remove the existing **Griffith University Wi-Fi profile** on your device.

- 1 Open **Settings** and select **General**.

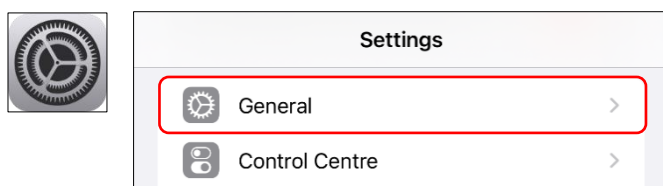

- 2 Scroll down and select **VPN & Device Management**.

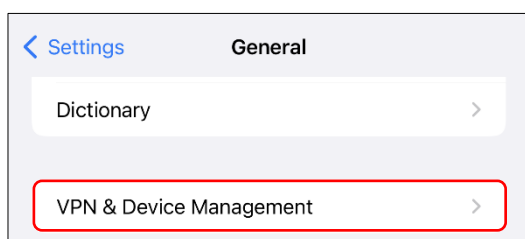

- 3 Tap on **Griffith University Wifi Settings** and select **Remove Profile**.

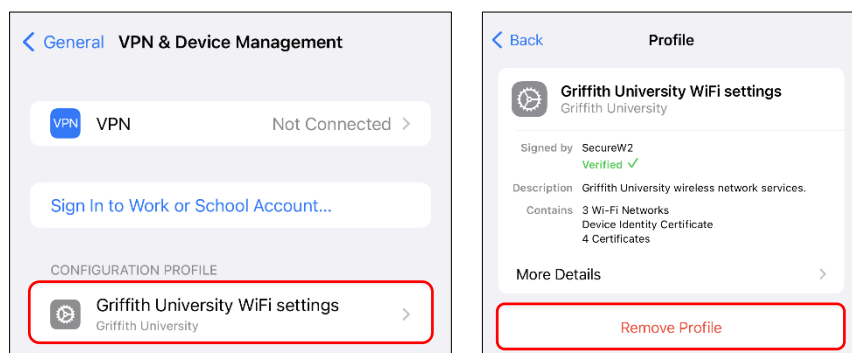

- 4 Enter the passcode for your device then select **Remove**. Once removed, continue to **Part A: Connect to \*Setup Griffith Wi-Fi**.

## Part A: Connect to \*Setup Griffith Wi-Fi

- 1 Open **Settings** on your device and select **Wi-Fi**.

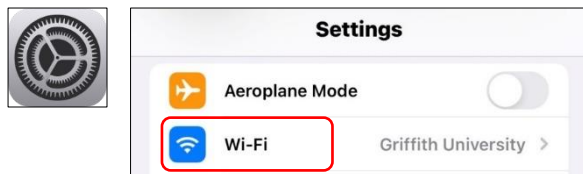

- 2 Tap on the **\*Setup Griffith Wi-Fi** network and wait for your device to connect.



- 3 Once connected the below prompt will appear. Tap **Done**.



## Part B: Download and set up SecureW2 JoinNow

- 1 Open **Safari** browser and go to <http://wifi.griffith.edu.au>

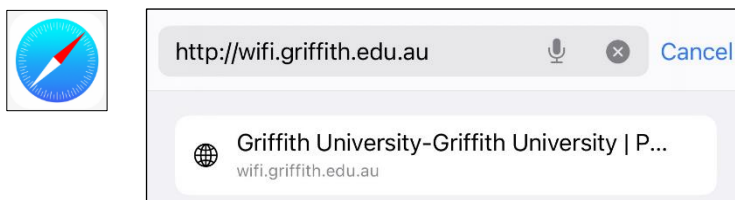

**2** Tap **Sign In**.

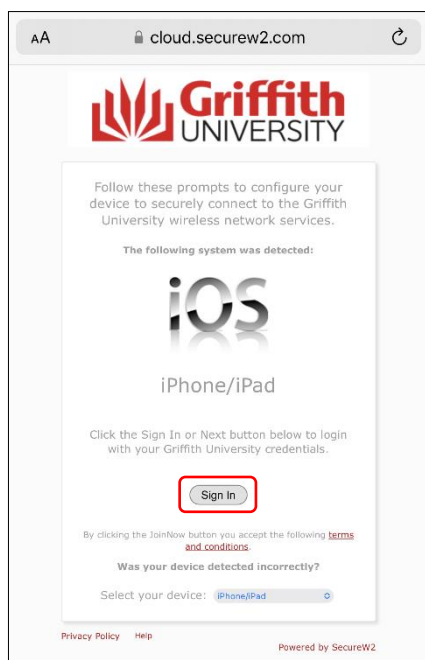

A screenshot of a mobile app interface for Griffith University. At the top, the browser address bar shows 'cloud.securew2.com'. Below is the Griffith University logo. The main text reads: 'Follow these prompts to configure your device to securely connect to the Griffith University wireless network services.' It then states: 'The following system was detected: iOS iPhone/iPad'. Below this, it says: 'Click the Sign In or Next button below to login with your Griffith University credentials.' A 'Sign In' button is highlighted with a red rectangle. At the bottom, there is a link for 'terms and conditions', a question 'Was your device detected incorrectly?', and a dropdown menu for 'Select your device:' currently showing 'iPhone/iPad'. Footer links include 'Privacy Policy', 'Help', and 'Powered by SecureW2'.

**3** Sign in with your **Griffith sNumber** and **Griffith password** (e.g. sXXXXXXX).



A screenshot of the 'Griffith Single Sign-On' login screen. It features the Griffith University logo at the top. Below the logo, the text 'Griffith Single Sign-On' is displayed. There are two input fields: 'Username' with the placeholder text 'sXXXXXXX' and 'Password'. Below the password field is a 'Login' button with a right-pointing arrow.

**4** Enter your **sNumber followed by @griffith.edu.au** (e.g. sXXXXXXX@griffith.edu.au) then click **JoinNow**.



A screenshot of a mobile app interface for Griffith University, similar to the first one. It shows the Griffith University logo and the same introductory text. It states: 'The following system was detected: iOS iPhone/iPad'. Below this, it says: 'Enter your Username (sNumber) followed by @griffith.edu.au. Click JoinNow.' It provides an example: 'e.g. s12345678@griffith.edu.au'. A text input field contains 'sXXXXXXX@griffith.edu.au' and is highlighted with a red rectangle. Below the input field is a 'JoinNow' button, also highlighted with a red rectangle.

- 5 If prompted, select **Allow** then select the device you are using (**iPhone** or **iPad**).

If you have an Apple Watch connected, you must ensure the profile installation occurs on the iPhone or iPad (not on the watch).

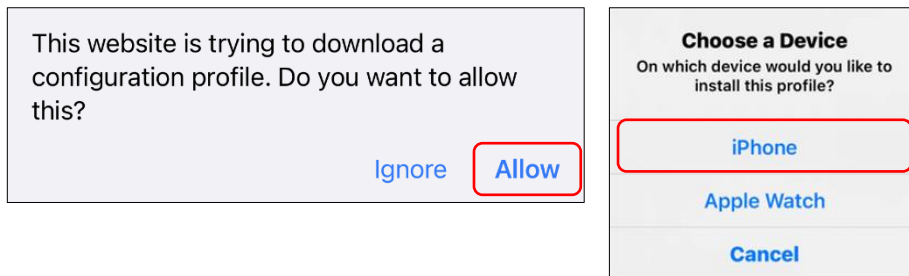

- 6 Open **Settings** and select **Profile Downloaded**.

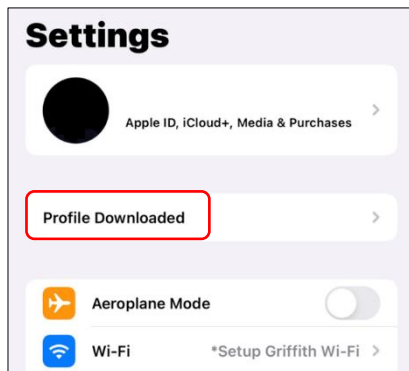

- 7 Select **Install** and enter your device's passcode when prompted.

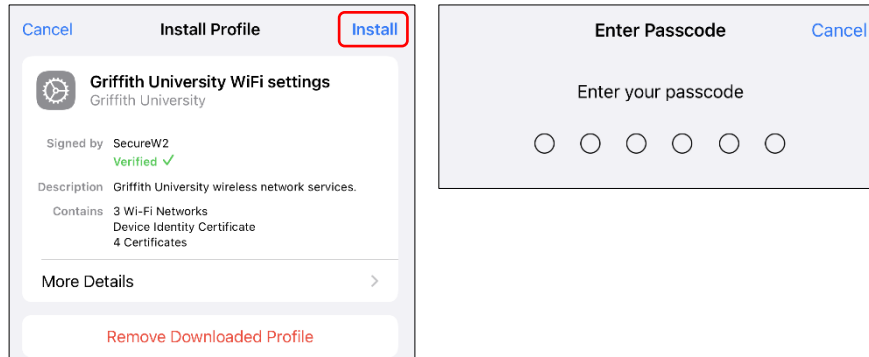

- 8 Select **Install** at the certificate warning and at the second prompt.

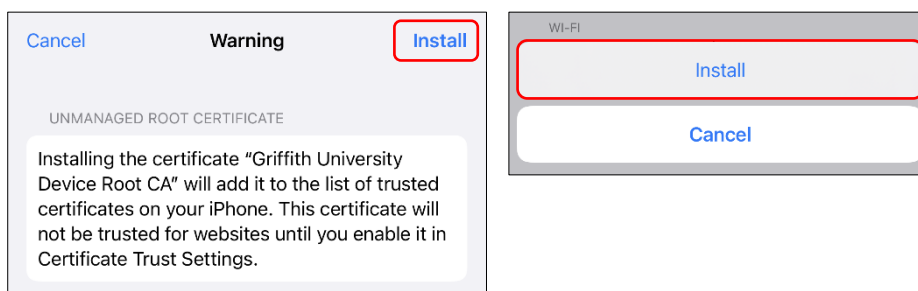

- 9 Enter your **Griffith password** then select **Next**.

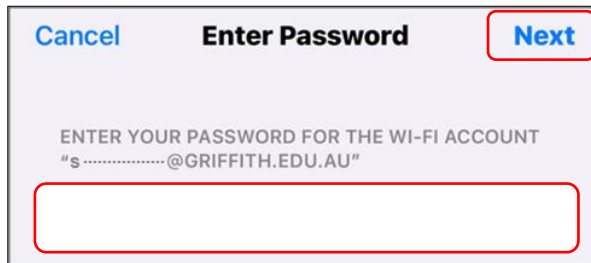

- 10 Select **Done**.

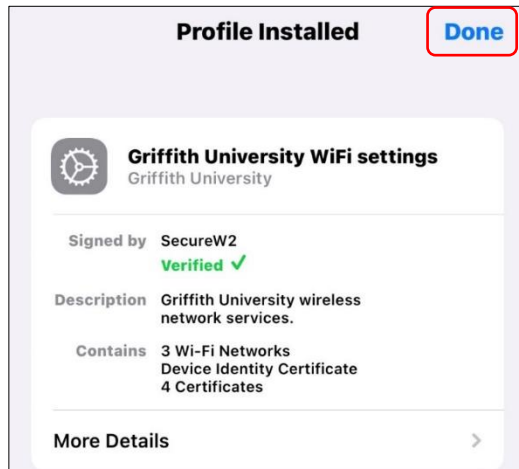

## Part C: Test your Wi-Fi connection

- 1 Open **Settings** and check your device is now connected to the **Griffith University** Wi-Fi network (it may take up to one minute for the network to appear).

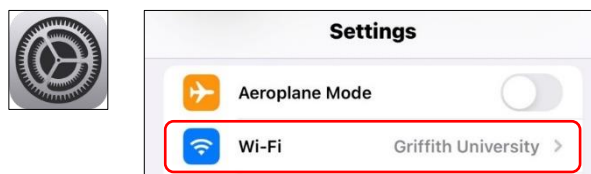

- 2 Once connected, try browsing the internet to check your connection to Griffith University Wi-Fi is working correctly.