

## Introduction

This guide will show you how to connect to Griffith University (Griffith) Wi-Fi on a Mac OS X.

## Step 1: Remove the existing Griffith Wi-Fi network on your device

- This step **must** be completed, or the setup process will fail. If you have never connected before, skip to **step 2**.

**1** Go to **system preferences** then select **Network**.

**2** Select **Wi-Fi** from the panel to the left, then select **Advanced**.

**3** Select the **Griffith University** and **eduroam** wi-fi networks. Deselect the **Auto-Join** boxes, then select **OK** and **Apply**.

**4** Close the **System Preference** box. Leaving it open may cause the configuration to fail.

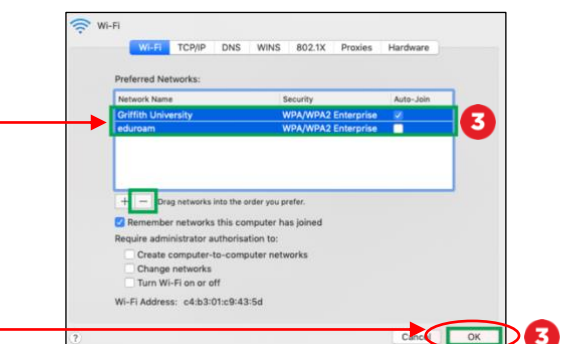
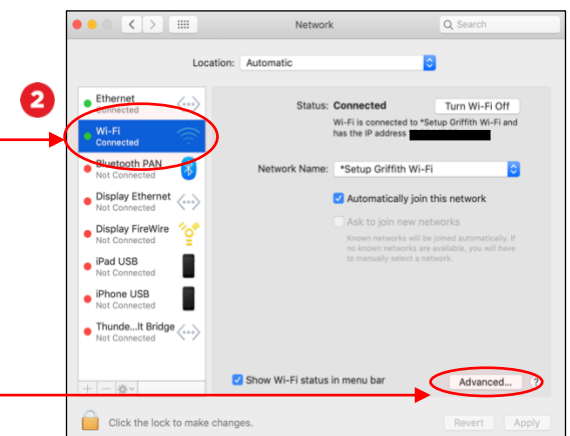
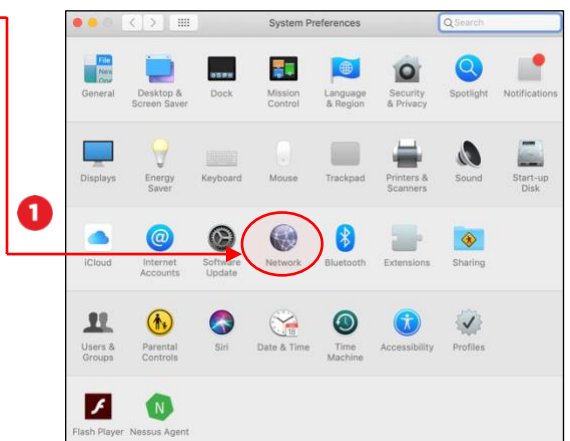

## Step 2: Connect to Griffith Wi-Fi

- 1 Under device **Wi-Fi** settings, select the **\*Setup Griffith Wi-Fi** network.



- 2 Open a web browser and go to **wifi.griffith.edu.au**.



- 3 The software will automatically detect the type of device you are using (for example, MacOS Catalina, Mojave, High Sierra etc).

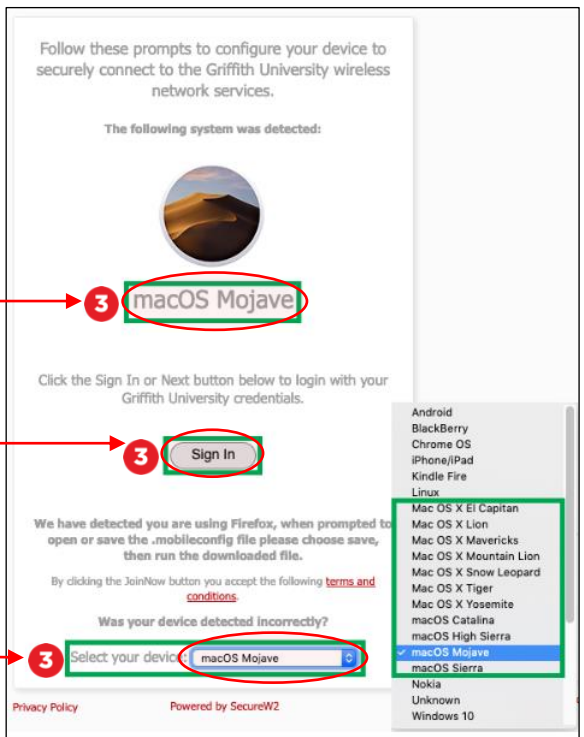

If the device detected is correct, select **Sign In**.

If the device detected is incorrect, select your device from the **drop-down list** and then **Sign In**.

- 4 Enter your Griffith login credentials and select **Login**.

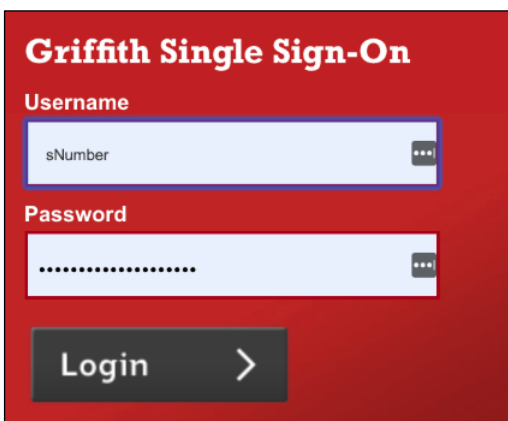

- 5 Enter your Griffith login credentials again here and select **Join Now**. This will also provide you access to the [eduroam](#) Wi-Fi network, which can be used when visiting other research and educational institutions connected to the eduroam network.

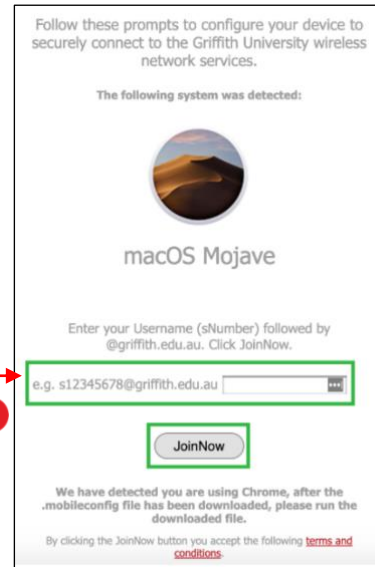

## Step 3: Configure the profile to your device

- 1 If prompted, select **allow downloads** from 'SecureW2.mobileconfig'. The downloaded file will run automatically.

If the file does not run automatically, go to Mac Downloads and select **Run SecureW2.mobileconfig**.

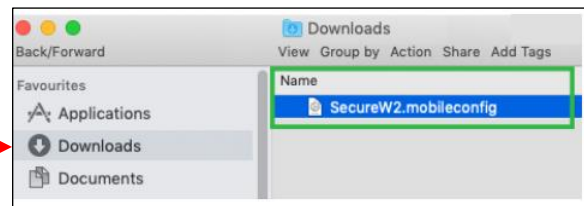

- 2 Select **Continue** when prompted to install Griffith University Wi-Fi settings.

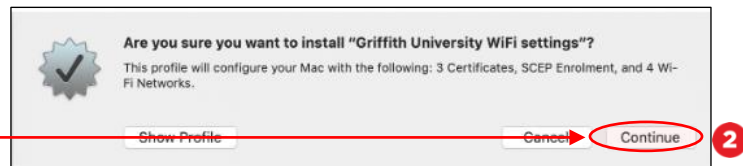

- 3 Select **Install** when prompted again to install Griffith University Wi-Fi settings.

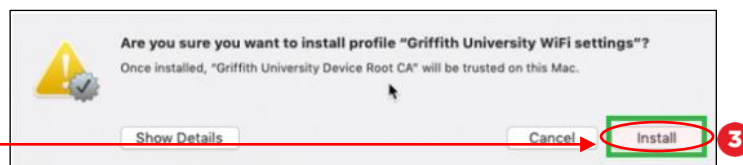

- 4 Enter your Griffith portal password when prompted for settings for eduroam and select **Install**.

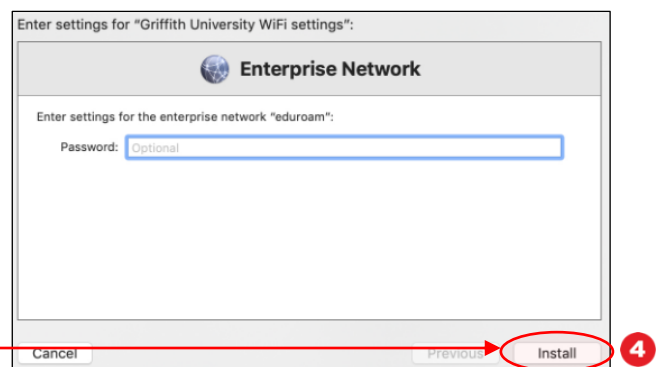

- 5 Enter your **Griffith portal password** when prompted for settings for eduroam and select **Install**.
- 6 Enter your **Mac administration credentials** and select **OK**.
- 7 The profile will be configured to your device. Once completed, you will be verified as connected to the Griffith University Wi-Fi network.

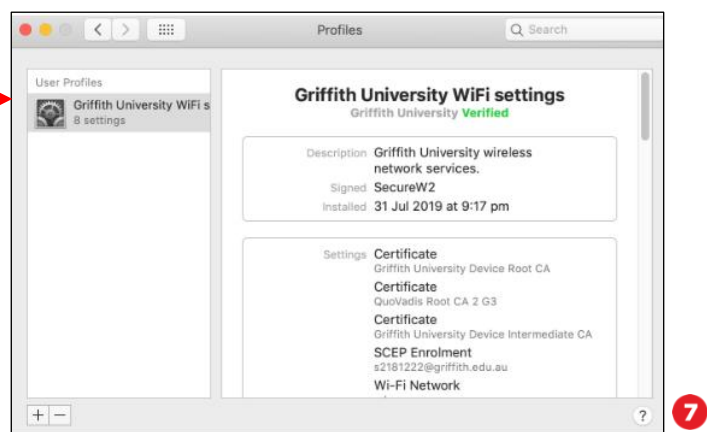
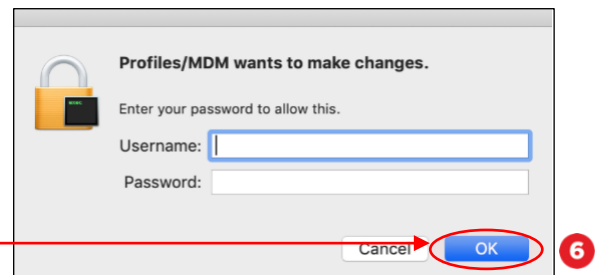
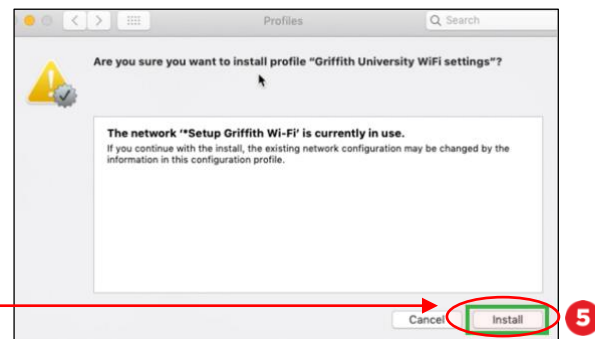

## Step 4: Complete the Wi-Fi Process

- 1 Select **Griffith University** as your preferred network under your Wi-Fi settings (it may take up to one minute for the network to appear).

You can now use the Griffith University Wi-Fi network. You might still be prompted to [log into your internet access](#) account when browsing the internet.

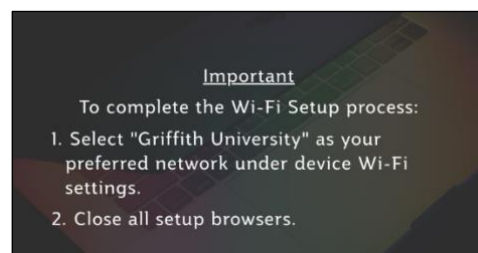

- 2 To check you are using secure Griffith Wi-Fi, go to your Mac **system preferences**, select **profile** and confirm it is set to **Griffith University Wi-Fi settings**.

