

Introduction

This guide will show you how to connect to Griffith University (Griffith) Wi-Fi on Android Devices. Please note Google devices need the SecureW2 JoinNow app to connect. **Do not remove this app or Griffith Wi-Fi will immediately terminate.**

Screen shots may differ

Step 1: Remove the existing Griffith Wi-Fi network on your device

- This step **must** be completed if you have used the network previously, or the setup process will fail. If you have never connected before, skip to **step 2**.

1 Go to **Settings > Network > Connections** and then **Manage known networks**.

2 Select the **Griffith University** network and select **Forget**.

3 Go to device Wi-Fi settings and select **Setup Griffith Wi-Fi**.

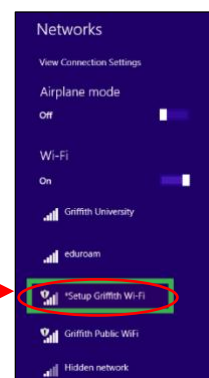
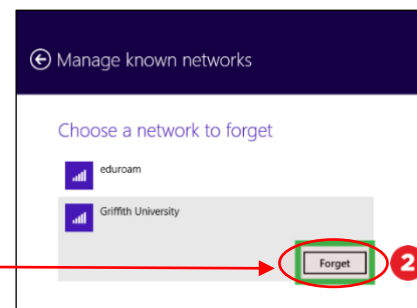
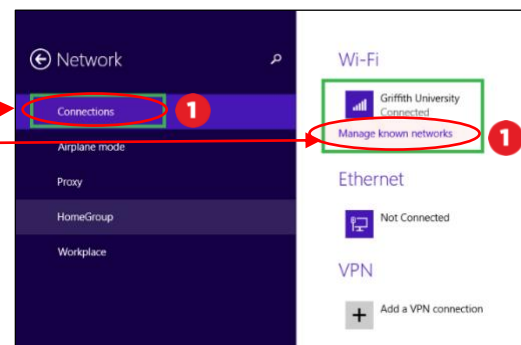

Step 2: Connect to Griffith Wi-Fi

- 1 Open a web browser and go to wifi.griffith.edu.au.



- 2 Select **Join Now**.

The software will automatically detect the type of device you are using (Windows 8 or 8.1). If the device detected is incorrect, select your device from the **drop-down list** and select **Join Now**.

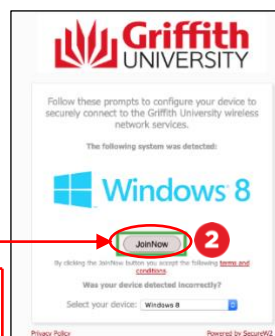

- 3 Select **Run** when prompted to download the application as an .exe file.

- 4 Select **Run** once the download has completed.

If the **SmartScreen** window appears, select **Run Anyway** to confirm the app is okay to run.

- 5 Select **Next**.

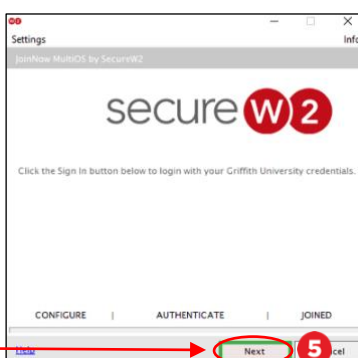
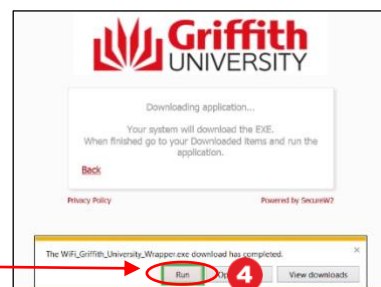
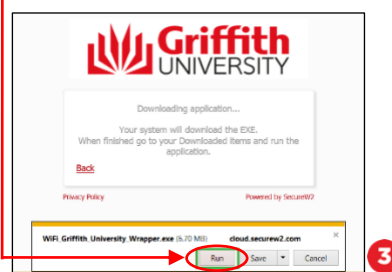

Step 3: Authenticate and complete Wi-Fi setup

1 Enter your Griffith credentials and select **Login**.

2 Enter your Griffith username followed by **@griffith.edu.au**, then your password and select **Next**.

These credentials will also provide you with access to the eduroam network when you visit other educational institutions in the eduroam federation. Find out more at griffith.edu.au/eduroam.

3 Wait for the device to configure and authenticate. Click **done** once completed.

4 Go back into your **Network settings**, select **Wi-Fi** and then select **Griffith University** as your preferred network (it may take up to one minute for the network to appear).

5 Close all setup browsers. You can now use the Griffith University Wi-Fi network. You may still be prompted to log into your internet access account when browsing the internet. Login at <https://ias.griffith.edu.au/griffith/portal/login>.

